

**LET'S GO
FOR A SPIN.**



HINKLEY

FAN SUPPLEMENT 2021

HINKLEY

THIS SUPPLEMENT INCLUDES ALL NEW FANS AND ACCESSORIES.
FOR A COMPLETE PRODUCT OFFERING, VISIT HINKLEY.COM.

HINKLEY, INC. | 2021



**HINKLEY FANS ARE HERE.
AND THEY ARE GUARANTEED TO KEEP YOU COOL.**

ABOVE: MARIN FAN 903160FMW-NDD | PAGE 18
CREW WALL MOUNT 2695 BK
HINKLEY.COM

this is
HINKLEY

LIGHTING + CEILING FANS MADE FOR *life*

style



Creativity is what drives us. Our team of designers is always trend-spotting and travels the globe to seek out inspiring styles.

quality



Quality is paramount, from construction all the way to customer service. We combine thoughtful design, technical innovation and a stylish state of mind into every Hinkley product.

heritage



It means a lot to us that people welcome Hinkley into their homes. It's the heart and soul of our company and it's been that way since 1922.

*curated
collections*



We started as a small outdoor lantern company and have expanded to bring you the best in Interior, Bath, Outdoor and Landscape Lighting as well as Ceiling Fans.

41° 29' 30.156" N



82° 1' 8.292" W

Hinkley is located off the shores of Lake Erie in Cleveland, Ohio and we wouldn't have it any other way.



A NOTE FROM JESS & ERIC

Our roots in design run deep. We grew up in a family business that treasures craftsmanship and quality. Our dad always taught us to cherish creativity and made sure we understood the significance of our products: each piece reflects your personal style and is meant to enhance the comfort and enjoyment of your home.

Thoughtful construction inspired by the best and latest trends, impeccable attention to detail and superior quality are the backbone of every single Hinkley design. Our great-grandfather started this company with those values, and it's still what our family stands for almost 100 years later.

We're excited to share our latest designs with you throughout these pages, and invite you to check out Hinkley.com to see all we have to offer.

Cheers to being happy at home,

Jess & Eric



WE KNOW COOL.

WE HAVE A NEW SPIN ON THINGS: UNIQUE CEILING FAN DESIGNS INSPIRED BY THE COOLEST HINKLEY LIGHTING STYLES. OUR BREEZY NEW BEAUTIES ARE ON THE MOVE. LET'S GO >



TABLE OF CONTENTS

ICONS + FINISH REFERENCES

Every Hinkley product is thoughtfully designed and carefully crafted with important features, so we've created useful icons and finish codes to help you with your lighting selections. Below is a key describing each of these icons in detail as well as a list of our extensive product finishes with abbreviated codes for easy reference.

FANS

52" AFTON	48
44" CHISEL	36
52" CHISEL	34
60" CHISEL	32
54" COLLIER	20
56" HAMPTON	16
72" INDY	26
82" INDY MAXX	24
99" INDY MAXX	22
60" MARIN	18
52" METRO	54
52" METRO ILLUMINATED	56
52" METRO WET	58
52" OASIS	52
60" OASIS	50
36" SAWYER	14
60" SCULPT	30
80" SCULPT	28
60" SWELL	40
80" SWELL	38
44" TREY	42
44" VENTUS	44

ACCESSORY BLADES

DOWNRODS	62
----------	----

LED LIGHT KITS	60
----------------	----

LIGHT KIT COVERS	61
------------------	----

WALL CONTROLS	63
---------------	----

ICON DESCRIPTIONS



DAMP

DAMP RATED

Suitable for use in damp (interior moist and outdoor no direct rain or sprinkler) locations as defined by NEC and CEC. Meets United States UL Underwriters Laboratories & CSA Canadian Standards Association Product Safety Standards.



DC MOTOR

DC MOTOR

Fan comes equipped with a DC motor which uses up to 70% less energy than an AC motor and runs cooler and quieter for a longer life.



Intertek

ETL LISTED

Fan has been tested by Intertek and found in compliance with accepted national safety standards.



LED

LED

Fan supplied with fully integrated LEDs and drivers or specifically matched LED lamps based on performance and application.



TITLE 24

TITLE 24

Meets California Energy Commission Title regulations.



UL LISTED

UL LISTED

Fan has been tested by Underwriters Laboratories and found in compliance with accepted national safety standards.



WET

WET RATED

Suitable for use in wet (interior direct splash and outdoor direct rain or sprinkler) locations as defined by NEC and CEC. Meets United States UL Underwriters Laboratories & CSA Canadian Standards Association Product Safety Standards.



WiFi

Fan is WiFi compatible with the purchase of optional controls.

FINISH CODES + NAMES

FAW	APPLIANCE WHITE	FMM	METALLIC MATTE BRONZE
FBN	BRUSHED NICKEL	FMW	MATTE WHITE
FCW	CHALK WHITE	FPW	PEWTER
FGT	GRAPHITE	FSS	STAINLESS STEEL
FHB	HERITAGE BRASS	FWH	WHITE
FMB	MATTE BLACK		

PICTORIAL INDEX

HINKLEY FANS



44" CHISEL
903744

Page 36

Graphite, Matte Black, Matte White



52" CHISEL
903752

Page 34

Graphite, Matte Black, Matte White



60" CHISEL
903760

Page 32

Graphite, Matte Black, Matte White



54" COLLIER
903254

Page 20

Heritage Brass, Matte Black,
Metallic Matte Bronze, Pewter



56" HAMPTON
903056

Page 16

Brushed Nickel, Heritage Brass,
Metallic Matte Bronze



72" INDY
900972

Page 26

Brushed Nickel, Matte Black,
Matte White, Metallic Matte Bronze



82" INDY MAXX
900982

Page 24

Brushed Nickel, Matte Black,
Matte White, Metallic Matte Bronze



99" INDY MAXX
900999

Page 22

Brushed Nickel, Matte Black,
Matte White, Metallic Matte Bronze



60" MARIN
903160

Page 18

Matte White, Metallic Matte Bronze



28" SAWYER
902928

Page 14

Matte Black, Matte White,
Metallic Matte Bronze



60" SCULPT
903660

Page 30

Graphite, Matte Black



80" SCULPT
903680

Page 28

Graphite, Matte Black



PICTORIAL INDEX



60" SWELL
903860
 Page 40
 Graphite, Matte Black



80" SWELL
903880
 Page 38
 Graphite, Matte Black



44" TREY
902744
 Page 42
 Brushed Nickel, Matte White,
 Metallic Matte Bronze



44" VENTUS
902844
 Page 44
 Matte White,
 Metallic Matte Bronze, Pewter



REGENCY SERIES



52" AFTON
903552
 Page 48
 Chalk White, Matte Black, Metallic
 Matte Bronze, Stainless Steel



52" METRO
903352
 Page 54
 Brushed Nickel, Chalk White,
 Matte Black, Metallic Matte Bronze



52" METRO ILLUMINATED
903352
 Page 56
 Brushed Nickel, Chalk White,
 Matte Black, Metallic Matte Bronze



52" METRO WET
903352
 Page 58
 Brushed Nickel, Chalk White,
 Matte Black, Metallic Matte Bronze



52" OASIS
901652
 Page 52
 Appliance White, Brushed Nickel,
 Graphite, Chalk White, Matte Black,
 Metallic Matte Bronze



60" OASIS
901660
 Page 50
 Brushed Nickel, Graphite,
 Chalk White, Matte Black,
 Metallic Matte Bronze





YOUR SPACE JUST GOT SMARTER

WHY A WIFI ENABLED FAN IS THE WAY TO GO



Adding WiFi controls connect Hinkley fans to a home's digital hub.



Voice activation is a must for hands-free ease of use.



Speed, light and seasonal modes are just a tap away. From anywhere, anytime.



Make life seamless by setting schedules and preferences.

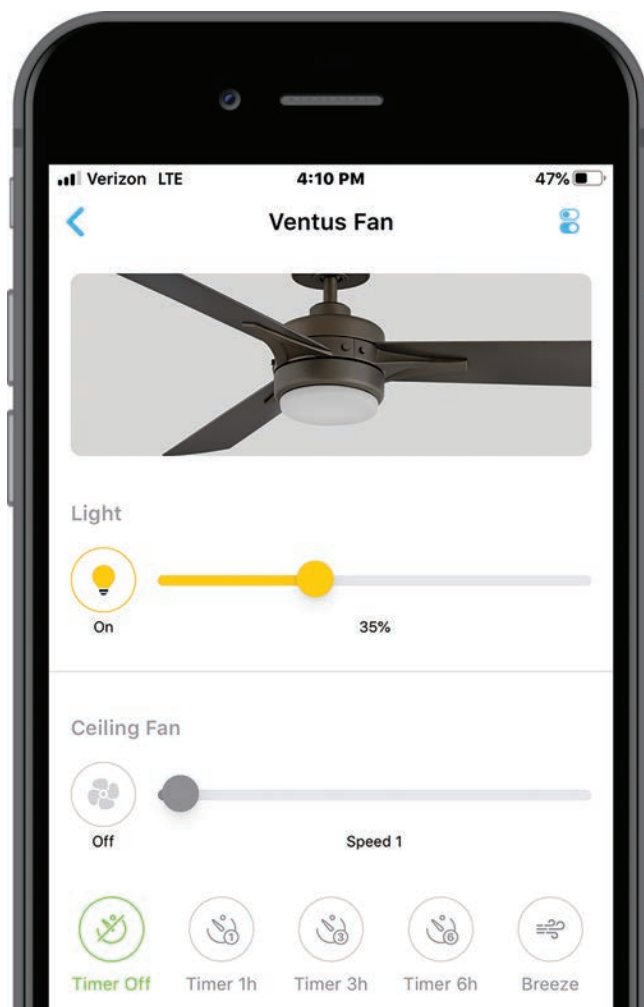

Add a WiFi optional control to any Hinkley fan to make it a smart fan. Refer to "Optional Controls" on each product page for compatible WiFi controls.

SETUP IN 5 SIMPLE STEPS



DOWNLOAD THE BOND APP

Once you've downloaded the app, login or create an account.



ADD YOUR HINKLEY FAN

Tap the "+" button to add a device. Select "Smart by Bond" option. Connect to "Bond Config" WiFi network. Test your ceiling fan.



SET CONTROLS & PREFERENCES

At this time you can set a location and name. These settings can be easily changed later under Device Settings.



CONNECT TO HOME WIFI

A list of WiFi networks will appear in the Smart by Bond app. Connect to your WiFi network.



DONE!

You're all set! You can now turn your fan on and off, adjust speed, light brightness, set timers and configure summer and winter modes. All of these features are compatible with smart home device voice controls.

SMART HOME COMPATIBLE

Smart by Bond is compatible with Amazon Alexa, Google Assistant, Smart Things, Control 4, Hubitat, Homebridge, ELAN, and RTI to seamlessly integrate Hinkley fans into your connected home.

 amazon alexa  Google Assistant  SmartThings

Control4  Hubitat

SMART BY BOND CUSTOMER SUPPORT

Smart by Bond has friendly agents standing by at least 12 hours per day to support you in live chat. If they do miss you, they will get back to you by email. For more information visit bondhome.io.



FAN DNA

FOR FAN NEWBIES AND AMBITIOUS PEOPLE WHO READ ALL OF THE INSTRUCTIONS BEFORE PUTTING STUFF TOGETHER

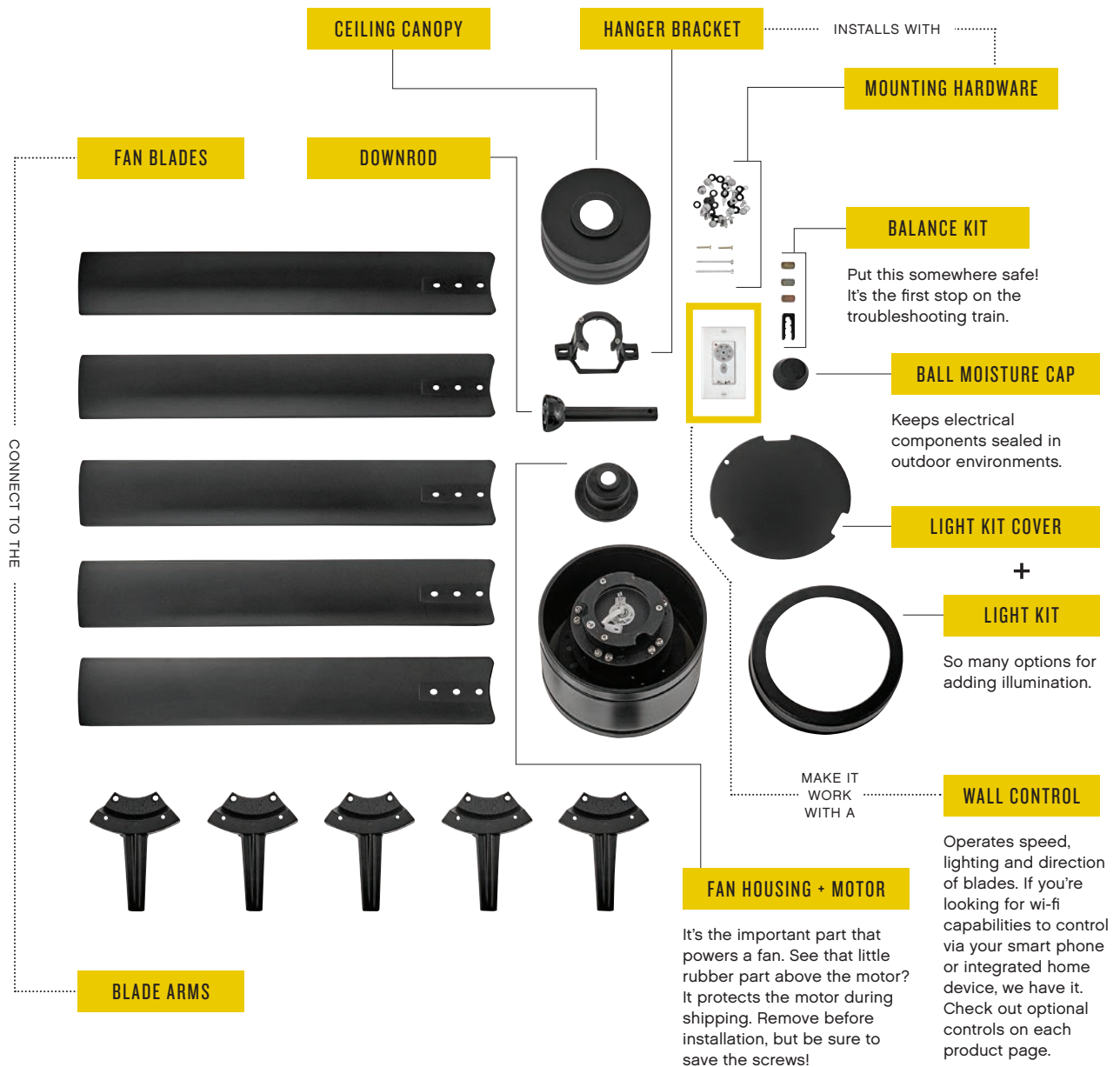

BANISH BUYING ANXIETY! MASTER THE MOST IMPORTANT FACTORS FOR

SELECTING A CEILING FAN

THE VERY FIRST THING
TO CONSIDER IS...

1 Location

Inside? Outside? Under cover? Wet rated fans are a must in any area exposed to the elements. Spaces like covered porches and sunrooms are best served by outdoor fans when condensation and high humidity are factors. Wet rated fans can be used inside as well, but indoor-only fans can't play outside.

2 Style

Narrow your search by finding fans that complement your home's décor. Go for modern if a streamlined look is more your style or check out traditional fans if they best suit your space. From island-inspired to mid-century, Hinkley has a fan (with plenty of finish and blade options) to fit your vibe.

3 Size

Choosing the right size fan is important. A fan that is too large can overpower a room, and too small will not circulate enough air. These guidelines will help:

SQUARE FOOTAGE OF ROOM + BLADE SWEEP = PERFECT FAN RATIO

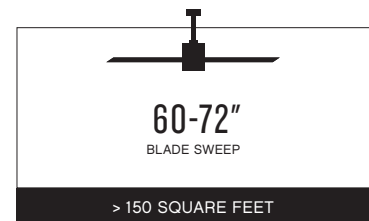
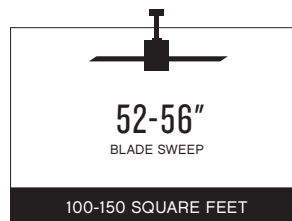
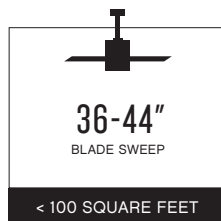

4 Airflow

UNDERSTANDING CFM:
CONVERTING ENERGY TO AIRFLOW

CFM is the magic acronym needed to achieve the optimum airflow output of a fan. It also calculates the operating cost and energy expenditure of your fan. So what actually is CFM?

THE VELOCITY OF AIRFLOW,
MEASURED IN
CUBIC FEET PER MINUTE

IF YOU WANT GREAT AIRFLOW,
LOOK FOR A FAN WITH A CFM
RATING OF 5,000 OR HIGHER.

MORE IS BETTER WHEN YOU'RE SPEAKING CEILING FAN CFM

7 Motor

THERE ARE 2 TYPES OF FAN MOTORS:

AC

Also known as a spinner motor fan.

DC

Use up to 70% less energy than an AC motor fan. They run cooler and quieter for longer life!

5 Light

BECAUSE SOMETIMES YOU JUST NEED OVER-HEAD LIGHTING. LED LIGHT KITS ARE EITHER INCLUDED OR OFFERED AS OPTIONAL ACCESSORIES FOR ALL FANS.

6 Control

Fans now have far more options than pull chains to operate! Look for included or optional accessories to make your fan WiFi compatible for smart phone control and integrate with home devices like Alexa and Google Assistant for voice activation.

8 Customize

Fans are cool because you can customize both aesthetic and operational elements. If you are the kind of person who rearranges your furniture and swaps out throw pillows seasonally, look for fans with reversible blades. If creating a connected home is at the top of your to-do list, check out the many options for controls.



36" SAWYER™

The fresh, rustic design of Sawyer will inject any outdoor living experience with the warm, cozy ambiance of an indoor setting. Available in Metallic Matte Bronze with Sequoia, Matte White with Weather Wood or Matte Black with Driftwood, Sawyer features composite blades. Sawyer is so versatile; it can be used for both indoor and outdoor spaces.



902928FMM-LWD
METALLIC MATTE BRONZE WITH SEQUOIA
ACCENTS AND SEQUOIA BLADES

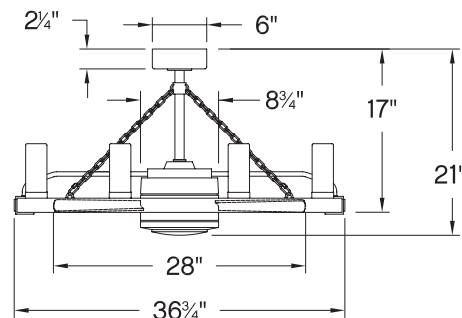

36" SAWYER™ WITH 28" FAN

902928FMB-LWD - MATTE BLACK

902928FMW-LWD - MATTE WHITE

902928FMM-LWD - METALLIC MATTE BRONZE

BLADES:

- 5 Composite Blades Included
- 16° Blade Pitch
- 28" Blade Sweep

MOUNTING:

- 12" & 24" Downrod Included
- 76" Lead Wire
- 29.98 lbs. Hanging Weight
- Mounts to Sloped Ceilings
- Up to 20° Pitch

Slope ceiling kit required for ceiling pitch greater than 20°, 992001FXX, see page 62.

LAMPING / GLASS:

- 8-4w Cand. LED Included
- 2400 Lumens | 90 CRI | 3000K
- Dimmable
- Clear Seedy Glass

INCLUDED CONTROLS:

980013FAS

Wall Control 6 Speed DC Reversing



Sawyer fans require a single power source for operation.



902928FMW-LWD
MATTE WHITE WITH WEATHERED WOOD ACCENTS
AND WEATHERED WOOD BLADES



902928FMB-LWD
MATTE BLACK WITH DRIFTWOOD
ACCENTS AND DRIFTWOOD BLADES

OPTIONAL CONTROLS:

1. **980003FWH**
Remote Control 6 Speed DC
2. **980015FAS-029**
WiFi Module DC Sawyer



1.



2.



PERFORMANCE SPECIFICATIONS	STANDARD	
	HIGH SPEED	AVERAGE
AIRFLOW (CFM)	2432	1637
ENERGY USE (WATTS)	10.7	8
AIRFLOW EFFICIENCY (CFM/W)	227	201
ENERGY COSTS (YEARLY)	\$3.00	\$2.00
AMPS	0.19	0.12
RPMS	319	211

56" HAMPTON™

Hampton is a modern transitional design, offering the ultimate in urban sophistication. The minimal, rectangular frame, paired with a decorative acrylic etched bottom lens and sleek blades is softened by a contemporary off-white linen drum shade. Available in Metallic Matte Bronze with Walnut or Metallic Matte Bronze blades, Brushed Nickel with Walnut or Silver blades, Heritage Brass with Birch or Matte White blades, Hampton is perfect for any interior decor.



903056FBN-LID
BRUSHED NICKEL WITH REVERSIBLE
SILVER / WALNUT BLADES

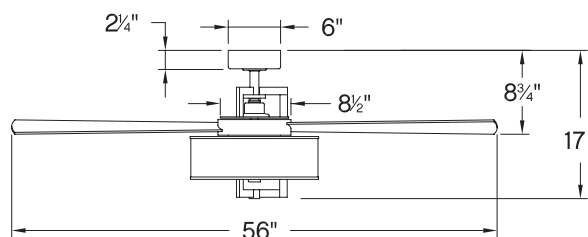

56" HAMPTON™

903056FBN-LID - BRUSHED NICKEL

903056FHB-LID - HERITAGE BRASS

903056FMM-LID - METALLIC MATTE BRONZE

BLADES:

- 5 Wood Blades Included
- 14° Blade Pitch
- 56" Blade Sweep

MOUNTING:

- 6" Downrod Included
- 76" Lead Wire
- 17.20 lbs. Hanging Weight
- Mounts to Sloped Ceilings
- Up to 20° Pitch

Slope ceiling kit required for ceiling pitch greater than 20°, 992001FXX, see page 62.

LAMPING / SHADE:

- 26w LED Included
- 2800 Lumens | 80 CRI | 3000K
- Dimmable
- White Linen Shade
- Etched Acrylic Lens

INCLUDED CONTROLS:

980013FAS
Wall Control 6 Speed DC
Reversing



Hampton fans require a single power source for operation.



903056FHB-LID
HERITAGE BRASS WITH REVERSIBLE
BIRCH / MATTE WHITE BLADES



903056FMM-LID
METALLIC MATTE BRONZE WITH REVERSIBLE
METALLIC MATTE BRONZE / WALNUT BLADES

REVERSIBLE BLADES:



BRUSHED NICKEL
Silver / Walnut



HERITAGE BRASS
Birch / Matte White



**METALLIC MATTE
BRONZE**
Metallic Matte Bronze /
Walnut

OPTIONAL CONTROLS:

1. 980003FWH

Remote Control 6 Speed DC

2. 980015FAS-030

WiFi Module DC Hampton



1.



2.



PERFORMANCE SPECIFICATIONS	STANDARD	
	HIGH SPEED	AVERAGE
AIRFLOW (CFM)	5233	3722
ENERGY USE (WATTS)	30.1	18
AIRFLOW EFFICIENCY (CFM/W)	174	202
ENERGY COSTS (YEARLY)	\$8.00	\$5.00
AMPS	0.41	0.23
RPMS	123	84

60" MARIN™

Modern meets maritime in the sleek Marin. Designed with a nautical flair in mind, Marin is available in Matte White with Weathered Wood blades, and Metallic Matte Bronze with Walnut blades and features composite blades. Marin is so versatile; it can be used for both indoor and outdoor spaces.



903160FMW-NDD
MATTE WHITE WITH
WEATHERED WOOD BLADES

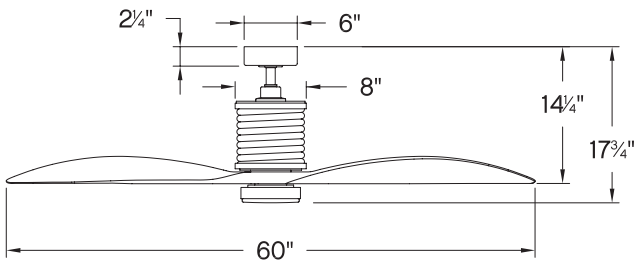

60" MARIN™

903160FMW-NDD - MATTE WHITE

903160FMM-NDD - METALLIC MATTE BRONZE

BLADES:

- 3 Composite Blades Included
- 16° Blade Pitch
- 60" Blade Sweep

MOUNTING:

- 4.5" Downrod Included
- 76" Lead Wire
- 20.94 lbs. Hanging Weight
- Mounts to Sloped Ceilings
- Up to 20° Pitch

Slope ceiling kit required for ceiling pitch greater than 20°, 992001FXX, see page 62.

LAMPING / GLASS:

- 16w LED Included
- 1500 Lumens | 90 CRI | 3000K
- Dimmable
- Etched Opal Glass

INCLUDED CONTROLS:

980013FAS

Wall Control 6 Speed DC Reversing



Marin fans require a single power source for operation.



903160FMM-NDD
METALLIC MATTE BRONZE WITH
WALNUT BLADES

OPTIONAL ACCESSORIES:

For additional finishes,
accessories and specifications,
see page 60.



932007FMW
Light Kit Cover
Included with Fan

OPTIONAL CONTROLS:

1. **980003FWH**
Remote Control 6 Speed DC

2. **980015FAS-031**
WiFi Module DC Marin

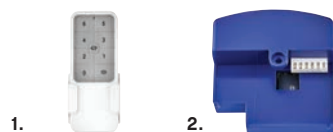

PERFORMANCE SPECIFICATIONS	STANDARD	
	HIGH SPEED	AVERAGE
AIRFLOW (CFM)	6339	4601
ENERGY USE (WATTS)	26.5	17
AIRFLOW EFFICIENCY (CFM/W)	239	273
ENERGY COSTS (YEARLY)	\$7.00	\$5.00
AMPS	0.36	0.21
RPMS	105	75

54" COLLIER™

Collier's mid-century silhouette incorporates the best in retro simplicity. Cast knobs, hinges and stems convey sleek elegance for a look that is at once modern and timeless. Available in Heritage Brass with Birch or Walnut blades, Matte Black with Walnut or Matte Black blades, Metallic Matte Bronze with Walnut or Metallic Matte Bronze blades, and Pewter with Matte Black or Birch blades, Collier features wood blades.



903254FHB-LID
HERITAGE BRASS WITH REVERSIBLE
BIRCH / WALNUT BLADES

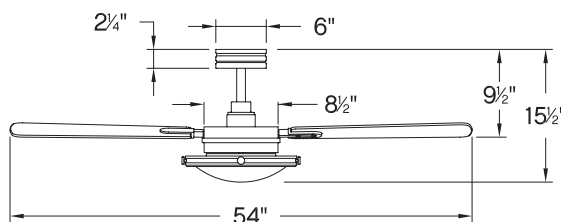

54" COLLIER™

903254FHB-LID - HERITAGE BRASS

903254FMB-LID - MATTE BLACK

903254FMM-LID - METALLIC MATTE BRONZE

903254FPW-LID - PEWTER

BLADES:

- 4 Wood Blades Included
- 13° Blade Pitch
- 54" Blade Sweep

MOUNTING:

- 6" Downrod Included
- 76" Lead Wire
- 17.86 lbs. Hanging Weight
- Mounts to Sloped Ceilings
- Up to 20° Pitch

Slope ceiling kit required for ceiling pitch greater than 20°, 992001FXX, see page 62.

LAMPING / GLASS:

- 24w LED Included
- 2400 Lumens | 90 CRI | 3000K
- Dimmable
- Etched Opal Glass

INCLUDED CONTROLS:

980013FAS

Wall Control 6 Speed DC Reversing



Collier fans require a single power source for operation.



903254FMB-LID
MATTE BLACK WITH REVERSIBLE
MATTE BLACK / WALNUT BLADES



903254FMM-LID
METALLIC MATTE BRONZE WITH REVERSIBLE
WALNUT / METALLIC MATTE BRONZE BLADES



903254FPW-LID
PEWTER WITH REVERSIBLE
MATTE BLACK / BIRCH BLADES

REVERSIBLE BLADES:



HERITAGE BRASS
Birch / Walnut



MATTE BLACK
Matte Black / Walnut



METALLIC MATTE BRONZE
Metallic Matte Bronze / Walnut



PEWTER
Birch / Matte Black

OPTIONAL CONTROLS:

1. **980003FWH**
Remote Control 6 Speed DC

2. **980015FAS-032**
WiFi Module DC Collier



PERFORMANCE SPECIFICATIONS	STANDARD	
	HIGH SPEED	AVERAGE
AIRFLOW (CFM)	5426	3617
ENERGY USE (WATTS)	34.1	20
AIRFLOW EFFICIENCY (CFM/W)	159	177
ENERGY COSTS (YEARLY)	\$10.00	\$6.00
AMPS	0.45	0.25
RPMS	148	97

99" INDY MAXX™

The raw, edgy style of Indy is the perfect complement for all modern industrial design-inspired rooms. Available in Brushed Nickel, Matte Black, Metallic Matte Bronze and Matte White, Indy Maxx features sleek aluminum blades. Indy Maxx is so versatile; it can be used for both indoor and outdoor spaces.



900999FMM-LDD
METALLIC MATTE BRONZE WITH
METALLIC MATTE BRONZE BLADES

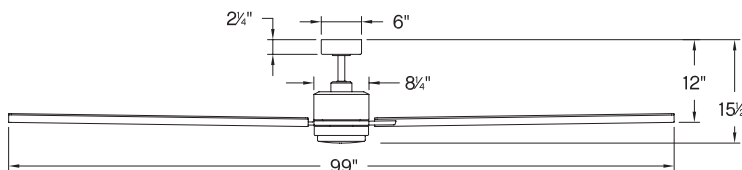

99" INDY MAXX™

900999FBN-LDD - BRUSHED NICKEL

900999FMB-LDD - MATTE BLACK

900999FMW-LDD - MATTE WHITE

900999FMM-LDD - METALLIC MATTE BRONZE

BLADES:

- 6 Aluminum Blades Included
- 20° Blade Pitch
- 99" Blade Sweep

MOUNTING:

- 6" Downrod Included
- 76" Lead Wire
- 40.92 lbs. Hanging Weight
- Mounts to Sloped Ceilings
- Up to 20° Pitch

Slope ceiling kit required for ceiling pitch greater than 20°, 992001FXX, see page 62.

LAMPING / GLASS:

- 16w LED Included
- 1500 Lumens | 90 CRI | 3000K
- Dimmable
- Etched Opal Glass

INCLUDED CONTROLS:

980013FAS

Wall Control 6 Speed DC Reversing
WiFi Adaptable
Controls Included



Indy Maxx fans require a single power source for operation.



900999FBN-LDD
BRUSHED NICKEL WITH
BRUSHED NICKEL BLADES



900999FMB-LDD
MATTE BLACK WITH
MATTE BLACK BLADES



900999FMW-LDD
MATTE WHITE WITH
MATTE WHITE BLADES

OPTIONAL ACCESSORIES:

For additional finishes,
accessories and specifications,
see page 60.



Light Kit Cover
Included with Fan

OPTIONAL CONTROLS:

1.980003FWH

Remote Control 6 Speed DC



1.

PERFORMANCE SPECIFICATIONS	STANDARD	
	HIGH SPEED	AVERAGE
AIRFLOW (CFM)	11010	8426
ENERGY USE (WATTS)	42.7	27
AIRFLOW EFFICIENCY (CFM/W)	258	312
ENERGY COSTS (YEARLY)	\$12.00	\$8.00
AMPS	0.52	0.32
RPMS	70	53

82" INDY MAXX™

The raw, edgy style of Indy is the perfect complement for all modern industrial design-inspired rooms. Available in Brushed Nickel, Matte Black, Metallic Matte Bronze and Matte White, Indy Maxx features sleek aluminum blades. Indy Maxx is so versatile; it can be used for both indoor and outdoor spaces.



900982FBN-LDD
BRUSHED NICKEL WITH
BRUSHED NICKEL BLADES

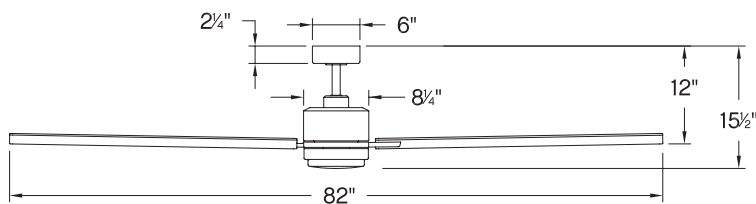

82" INDY MAXX™

900982FBN-LDD - BRUSHED NICKEL

900982FMB-LDD - MATTE BLACK

900982FMW-LDD - MATTE WHITE

900982FMM-LDD - METALLIC MATTE BRONZE

BLADES:

- 6 Aluminum Blades Included
- 20° Blade Pitch
- 82" Blade Sweep

MOUNTING:

- 6" Downrod Included
- 76" Lead Wire
- 37.10 lbs. Hanging Weight
- Mounts to Sloped Ceilings
- Up to 20° Pitch

Slope ceiling kit required for ceiling pitch greater than 20°, 992001FXX, see page 62.

LAMPING / GLASS:

- 16w LED Included
- 1500 Lumens | 90 CRI | 3000K
- Dimmable
- Etched Opal Glass

INCLUDED CONTROLS:

980013FAS

Wall Control 6 Speed DC Reversing
WiFi Adaptable
Controls Included



Indy Maxx fans require a single power source for operation.



900982FMB-LDD
MATTE BLACK WITH
MATTE BLACK BLADES



900982FMW-LDD
MATTE WHITE WITH
MATTE WHITE BLADES



900982FMM-LDD
METALLIC MATTE BRONZE WITH
METALLIC MATTE BRONZE BLADES

OPTIONAL ACCESSORIES:

For additional finishes,
accessories and specifications,
see page 60.

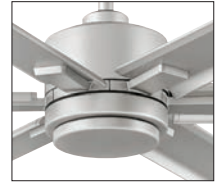

Light Kit Cover
Included with Fan

1.980003FWH
Remote Control 6 Speed DC



1.

PERFORMANCE SPECIFICATIONS	STANDARD	
	HIGH SPEED	LOW SPEED
AIRFLOW (CFM)	10242	7375
ENERGY USE (WATTS)	15.5	27
AIRFLOW EFFICIENCY (CFM/W)	661	269
ENERGY COSTS (YEARLY)	\$4.00	\$8.00
AMPS	0.64	0.36
RPMS	85	60

72" INDY™

The raw, edgy style of Indy is the perfect complement for all modern industrial design-inspired rooms.

Available in Brushed Nickel, Matte Black, Matte White or Metallic Matte Bronze finish options, Indy features sleek composite blades. Indy is so versatile; it can be used for both indoor and outdoor spaces. Blades are included with every fan.



900972FMB-NWA
MATTE BLACK WITH
MATTE BLACK BLADES

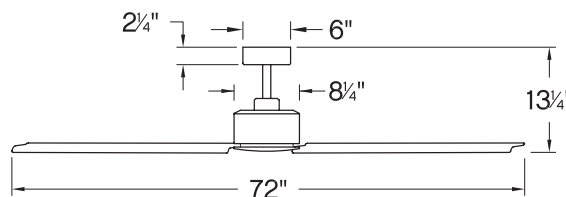

72" INDY™

900972FBN-NWA - BRUSHED NICKEL

900972FMB-NWA - MATTE BLACK

900972FMW-NWA - MATTE WHITE

900972FMM-NWA - METALLIC MATTE BRONZE

BLADES:

- 3 Composite Blades Included
- 55° Blade Pitch
- 72" Blade Sweep

MOUNTING:

- 6" Downrod Included
- 76" Lead Wire
- 23.72lbs. Hanging Weight
- Mounts to Sloped Ceilings
- Up to 20° Pitch

Slope ceiling kit required for ceiling pitch greater than 18°, 992001FXX, see page 62.

INCLUDED CONTROLS:

980011FWH
Wall Control 4 Speed Slide
Manual Reverse





900972FBN-NWA
BRUSHED NICKEL WITH
BRUSHED NICKEL BLADES



900972FMW-NWA
MATTE WHITE WITH
MATTE WHITE BLADES



900972FMM-NWA
METALLIC MATTE BRONZE WITH
METALLIC MATTE BRONZE BLADES

OPTIONAL CONTROLS:

1. **980004FWH-0097**
WiFi Remote Control 72" Indy
2. **980017FWH-0097**
WiFi Wall Control 72" Indy



WiFi compatible with optional controls.

PERFORMANCE SPECIFICATIONS	STANDARD	
	HIGH SPEED	AVERAGE
AIRFLOW (CFM)	6425	4465
ENERGY USE (WATTS)	62.6	39
AIRFLOW EFFICIENCY (CFM/W)	103	115
ENERGY COSTS (YEARLY)	\$18.00	\$11.00
AMPS	0.52	0.37
RPMS	83	71

OPTIONAL ACCESSORIES:

For additional finishes, accessories and specifications, see page 60.

80" SCULPT™

Sculpt defines modern elegance. Its Solid Wood blades are complemented by a clean etched opal glass, seamlessly adding the adequate amount of contemporary character. Sculpt features solid wood blades and is available in Matte Black with Walnut blades or Graphite with Driftwood blades. Sculpt is DAMP rated, making it perfect for both interior and outdoor settings.



903680FMB-LDD
MATTE BLACK WITH WALNUT BLADES

DC
DC MOTOR

LED

Intertek

T24
TITLE 24

DAMP

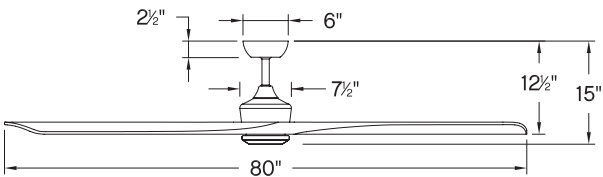

80" SCULPT™

903680FMB-LDD - MATTE BLACK

903680FGT-LDD - GRAPHITE

BLADES:

- 3 Wood Blades Included
- 14° Blade Pitch
- 80" Blade Sweep

MOUNTING:

- 6" Downrod Included
- 76" Lead Wire
- 19.18 lbs. Hanging Weight
- Mounts to Sloped Ceilings
- Up to 20° Pitch

Slope ceiling kit required for ceiling pitch greater than 20°, 992001FXX, see page 62.

LAMPING / GLASS:

- 16w LED Included
- 1500 Lumens | 90 CRI | 3000K
- Dimmable
- Etched Opal Glass

INCLUDED CONTROLS:

980013FAS

Wall Control 6 Speed DC Reversing



Sculpt fans require a single power source for operation.



903680FGT-LDD
GRAPHITE WITH DRIFTWOOD BLADES

OPTIONAL ACCESSORIES:

For additional finishes, accessories and specifications, see page 60.



Light Kit Cover
Included with Fan

OPTIONAL CONTROLS:

1. **980003FWH**
WiFi Wall Control

2. **980015FAS-0368**
WiFi Module DC 80" Sculpt



1.

2.

PERFORMANCE SPECIFICATIONS	STANDARD	
	HIGH SPEED	AVERAGE
AIRFLOW (CFM)	11023	8548
ENERGY USE (WATTS)	33.1	19.0
AIRFLOW EFFICIENCY (CFM/W)	333	439
ENERGY COSTS (YEARLY)	\$9.00	\$5.00
AMPS	0.47	0.28
RPMS	115	83

60" SCULPT™

Sculpt defines modern elegance. Its Solid Wood blades are complemented by a clean etched opal glass, seamlessly adding the adequate amount of contemporary character. Sculpt features solid wood blades and is available in Matte Black with Walnut blades or Graphite with Driftwood blades. Sculpt is DAMP rated, making it perfect for both interior and outdoor settings.



903660FGT-LDD
GRAPHITE WITH DRIFTWOOD BLADES

DC MOTOR

LED

TITL 24

DAMP

Intertek

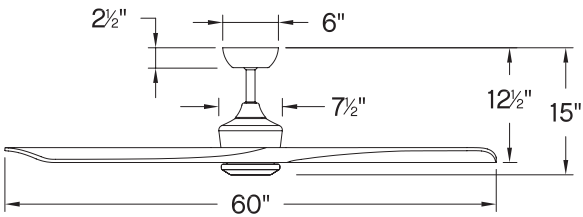

60" SCULPT™

903660FGT-LDD - GRAPHITE

903660FMB-LDD - MATTE BLACK

BLADES:

- 3 Wood Blades Included
- 14° Blade Pitch
- 60" Blade Sweep

MOUNTING:

- 6" Downrod Included
- 76" Lead Wire
- 17.2 lbs. Hanging Weight
- Mounts to Sloped Ceilings
- Up to 20° Pitch

Slope ceiling kit required for ceiling pitch greater than 20°, 992001FXX, see page 62.

LAMPING / GLASS:

- 16w LED Included
- 1500 Lumens | 90 CRI | 3000K
- Dimmable
- Etched Opal Glass

INCLUDED CONTROLS:

980013FAS

Wall Control 6 Speed DC Reversing



Sculpt fans require a single power source for operation.



903660FMB-LDD
MATTE BLACK WITH WALNUT BLADES

OPTIONAL ACCESSORIES:

For additional finishes, accessories and specifications, see page 60.



Light Kit Cover
Included with Fan

OPTIONAL CONTROLS:

1. **980003FWH**
WiFi Wall Control
2. **980015FAS-0366**
WiFi Module DC 60" Sculpt



1.



2.



PERFORMANCE SPECIFICATIONS	STANDARD	
	HIGH SPEED	AVERAGE
AIRFLOW (CFM)	8752	6079
ENERGY USE (WATTS)	32.4	20.0
AIRFLOW EFFICIENCY (CFM/W)	270	298
ENERGY COSTS (YEARLY)	\$9.00	\$6.00
AMPS	0.50	0.29
RPMS	185	119

60" CHISEL™

Built with a sleek, carefully crafted design, Chisel redefines dramatic style. Made of sturdy solid wood blades, Chisel is available in Matte Black with Walnut blades, Matte White with Weathered Wood blades, and Graphite with Driftwood blades. Chisel is DAMP rated, making it perfect for both interior and outdoor settings.



903760FGT-NDD
GRAPHITE WITH DRIFTWOOD BLADES

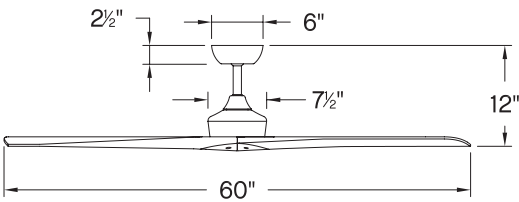

60" CHISEL™

- 903760FGT-NDD - GRAPHITE
- 903760FMB-NDD - MATTE BLACK
- 903760FMW-NDD - MATTE WHITE

BLADES:

- 3 Wood Blades Included
- 14° Blade Pitch
- 60" Blade Sweep

MOUNTING:

- 6" Downrod Included
- 76" Lead Wire
- 16.10 lbs. Hanging Weight
- Mounts to Sloped Ceilings
 - Up to 20° Pitch

Slope ceiling kit required for ceiling pitch greater than 20°, 992001FXX, see page 62.

INCLUDED CONTROLS:

- 980013FAS
Wall Control 6 Speed DC Reversing



Chisel fans require a single power source for operation.



903760FMB-NDD
MATTE BLACK WITH WALNUT BLADES



903760FMW-NDD
MATTE WHITE WITH WEATHERED WOOD BLADES

OPTIONAL CONTROLS:

1. **980003FWH**
Remote Control 6 Speed DC
2. **980015FAS-0376**
WiFi Module DC 60" Chisel



PERFORMANCE SPECIFICATIONS	STANDARD	
	HIGH SPEED	AVERAGE
AIRFLOW (CFM)	8035	5564
ENERGY USE (WATTS)	33.6	20.0
AIRFLOW EFFICIENCY (CFM/W)	239	282
ENERGY COSTS (YEARLY)	\$9.00	\$6.00
AMPS	0.48	0.28
RPMS	177	114

OPTIONAL ACCESSORIES:

For additional finishes, accessories and specifications, see see page 60.

52" CHISEL™

Built with a sleek, carefully crafted design, Chisel redefines dramatic style. Made of sturdy solid wood blades, Chisel is available in Matte Black with Walnut blades, Matte White with Weathered Wood blades, and Graphite with Driftwood blades. Chisel is DAMP rated, making it perfect for both interior and outdoor settings.



903752FGT-NDD
GRAPHITE WITH DRIFTWOOD BLADES

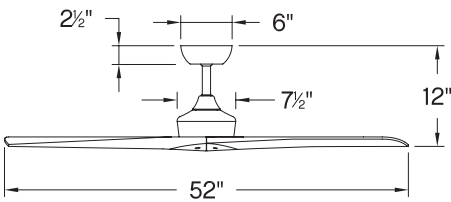

52" CHISEL™

- 903752FGT-NDD - GRAPHITE
- 903752FMB-NDD - MATTE BLACK
- 903752FMW-NDD - MATTE WHITE

BLADES:

- 3 Wood Blades Included
- 14° Blade Pitch
- 52" Blade Sweep

MOUNTING:

- 6" Downrod Included
- 76" Lead Wire
- 14.55 lbs. Hanging Weight
- Mounts to Sloped Ceilings
 - Up to 20° Pitch

Slope ceiling kit required for ceiling pitch greater than 20°, 992001FXX, see page 62.

INCLUDED CONTROLS:

- 980013FAS
Wall Control 6 Speed DC Reversing



Chisel fans require a single power source for operation.



903752FMB-NDD
MATTE BLACK WITH WALNUT BLADES



903752FMW-NDD
MATTE WHITE WITH WEATHERED WOOD BLADES

OPTIONAL CONTROLS:

1. **980003FWH**
Remote Control 6 Speed DC
2. **980015FAS-0375**
WiFi Module DC 52" Chisel



1.



2.



PERFORMANCE SPECIFICATIONS	STANDARD	
	HIGH SPEED	AVERAGE
AIRFLOW (CFM)	6564	4404
ENERGY USE (WATTS)	30.0	19.0
AIRFLOW EFFICIENCY (CFM/W)	219	233
ENERGY COSTS (YEARLY)	\$8.00	\$5.00
AMPS	0.46	0.27
RPMS	222	138

OPTIONAL ACCESSORIES:

For additional finishes, accessories and specifications, see see page 60.

44" CHISEL™

Built with a sleek, carefully crafted design, Chisel redefines dramatic style. Made of sturdy solid wood blades, Chisel is available in Matte Black with Walnut blades, Matte White with Weathered Wood blades, and Graphite with Driftwood blades. Chisel is DAMP rated, making it perfect for both interior and outdoor settings.



903744FGT-NDD
GRAPHITE WITH DRIFTWOOD BLADES

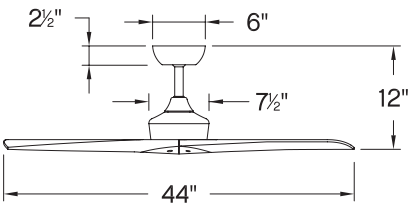

44" CHISEL™

903744FGT-NDD - GRAPHITE

903744FMB-NDD - MATTE BLACK

903744FMW-NDD - MATTE WHITE

BLADES:

- 3 Wood Blades Included
- 14° Blade Pitch
- 44" Blade Sweep

MOUNTING:

- 6" Downrod Included
- 76" Lead Wire
- 13.45 lbs. Hanging Weight
- Mounts to Sloped Ceilings
 - Up to 20° Pitch

Slope ceiling kit required for ceiling pitch greater than 20°, 992001FXX, see page 62.

INCLUDED CONTROLS:

980013FAS

Wall Control 6 Speed DC Reversing



Chisel fans require a single power source for operation.



903744FMB-NDD
MATTE BLACK WITH WALNUT BLADES



903744FMW-NDD
MATTE WHITE WITH WEATHERED WOOD BLADES

OPTIONAL CONTROLS:

1. **980003FWH**
Remote Control 6 Speed DC
2. **980015FAS-0374**
WiFi Module DC 44" Chisel



PERFORMANCE SPECIFICATIONS	STANDARD	
	HIGH SPEED	AVERAGE
AIRFLOW (CFM)	5032	3193
ENERGY USE (WATTS)	33.3	16.0
AIRFLOW EFFICIENCY (CFM/W)	151	200
ENERGY COSTS (YEARLY)	\$9.00	\$4.00
AMPS	0.36	0.21
RPMS	286	170

OPTIONAL ACCESSORIES:

For additional finishes, accessories and specifications, see see page 60.

80" SWELL™

Swell is sophisticated and distinct in design without sacrificing on its purpose. Available in Matte Black with Walnut blades or Graphite with Driftwood blades, Swell sets the tone for all contemporary spaces. Swell is DAMP rated, making it perfect for both interior and outdoor settings.



903880FMB-NDD
MATTE BLACK WITH WALNUT BLADES

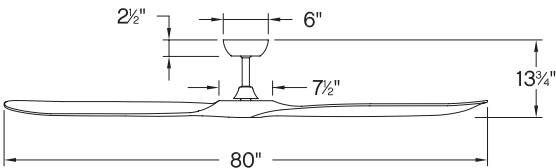

80" SWELL™
903880FGT-NDD - GRAPHITE
903880FMB-NDD - MATTE BLACK

- BLADES:**
- 3 Wood Blades Included
 - 14° Blade Pitch
 - 80" Blade Sweep

- MOUNTING:**
- 6" Downrod Included
 - 76" Lead Wire
 - 17.42 lbs. Hanging Weight
 - Mounts to Sloped Ceilings
- Up to 20° Pitch
- Slope ceiling kit required for ceiling pitch greater than 20°, 992001FXX, see page 62.

INCLUDED CONTROLS:
980013FAS
Wall Control 6 Speed DC Reversing



Swell fans require a single power source for operation.



903880FGT-NDD
GRAPHITE WITH DRIFTWOOD BLADES

OPTIONAL CONTROLS:

1. **980003FWH**
Remote Control 6 Speed DC
2. **980015FAS-0388**
WiFi Module DC 80" Swell



1.

2.

See hinkley.com for performance data.

OPTIONAL ACCESSORIES:

For additional finishes, accessories and specifications, see see page 60.

60" SWELL™

Swell is sophisticated and distinct in design without sacrificing on its purpose. Available in Matte Black with Walnut blades or Graphite with Driftwood blades, Swell sets the tone for all contemporary spaces. Swell is DAMP rated, making it perfect for both interior and outdoor settings.



903860FGT-NDD
GRAPHITE WITH DRIFTWOOD BLADES

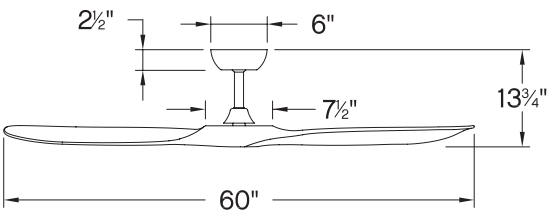

60" SWELL™
903860FGT-NDD - GRAPHITE
903860FMB-NDD - MATTE BLACK

- BLADES:**
- 3 Wood Blades Included
 - 14° Blade Pitch
 - 60" Blade Sweep
- MOUNTING:**
- 6" Downrod Included
 - 76" Lead Wire
 - 16.10 lbs. Hanging Weight
 - Mounts to Sloped Ceilings
 - Up to 20° Pitch
- Slope ceiling kit required for ceiling pitch greater than 20°, 992001FXX, see page 62.

INCLUDED CONTROLS:
980013FAS
Wall Control 6 Speed DC Reversing



Swell fans require a single power source for operation.



903860FMB-NDD
MATTE BLACK WITH WALNUT BLADES

OPTIONAL CONTROLS:

1. **980003FWH**
Remote Control 6 Speed DC
2. **980015FAS-0386**
WiFi Module DC 60" Swell



1.



2.



PERFORMANCE SPECIFICATIONS	STANDARD	
	HIGH SPEED	AVERAGE
AIRFLOW (CFM)	8752	6079
ENERGY USE (WATTS)	32.4	20.0
AIRFLOW EFFICIENCY (CFM/W)	270	298
ENERGY COSTS (YEARLY)	\$9.00	\$6.00
AMPS	0.50	0.29
RPMS	177	114

OPTIONAL ACCESSORIES:

For additional finishes, accessories and specifications, see see page 60.

44" TREY™

Trey features a sleek flush mount design that packs a powerful punch. Its transitional style comes equipped with robust blades that seamlessly pair performance and precision. Trey is offered in versatile Brushed Nickel with Silver blades, Metallic Matte Bronze with Metallic Matte Bronze blades, and Matte White with Matte White blades, and its integrated LED lighting and DC motor technology deliver excellent energy efficiency. A timeless etched opal light kit completes the look for a refined appearance. Trey is so versatile; it can be used for both indoor and outdoor spaces. Blades are included with every fan.



902744FBN-LWD
BRUSHED NICKEL WITH
SILVER BLADES

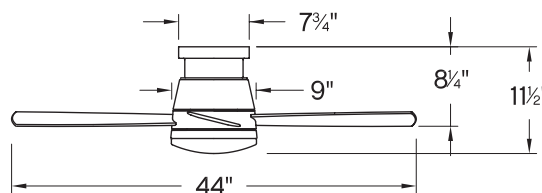

44" TREY™

902744FBN-LWD - BRUSHED NICKEL

902744FMW-LWD - MATTE WHITE

902744FMM-LWD - METALLIC MATTE BRONZE

BLADES:

- 3 Composite Blades Included
- 14° Blade Pitch
- 44" Blade Sweep

MOUNTING:

- 8" Lead Wire
- 14.82lbs. Hanging Weight

LAMPING / GLASS:

- 16w Integrated LED
- 1500 Lumens | 90 CRI | 3000K
- Dimmable
- Etched Opal Glass

INCLUDED CONTROLS:

980013FAS

Wall Control 6 Speed DC
Reversing



Trey fans require a single power source for operation.



902744FMW-LWD
MATTE WHITE WITH
MATTE WHITE BLADES



902744FMM-LWD
METALLIC MATTE BRONZE WITH
METALLIC MATTE BRONZE BLADES

OPTIONAL ACCESSORIES:

For additional finishes, accessories and specifications, see page 60.



932027FBN
Light Kit Cover

ADDITIONAL SIZES:

Also available in 52" diameter, refer to hinkley.com.

OPTIONAL CONTROLS:

1. **980003FWH**
Remote Control 6 Speed DC

2. **980015FAS-0274**
WiFi Accessory 44" Trey



PERFORMANCE SPECIFICATIONS	STANDARD	
	HIGH SPEED	AVERAGE
AIRFLOW (CFM)	4842	2918
ENERGY USE (WATTS)	31.6	19
AIRFLOW EFFICIENCY (CFM/W)	152	154
ENERGY COSTS (YEARLY)	\$9.00	\$5.00
AMPS	0.43	0.24
RPMS	260	153

44" VENTUS™

Ventus is the ultimate transitional style guaranteed to cool and complement any interior space. Unique and reversible blades are constructed to ensure maximum performance. Its finish options deliver a sophisticated appearance: Metallic Matte Bronze with Metallic Matte Bronze or Walnut blades, Matte White with Matte White or Weathered Wood blades, and Pewter with Driftwood or Teak blades. Ventus is equipped with integrated LED lighting technology to deliver excellent energy efficiency. Blades are included with every fan.



902844FMW-LIA
MATTE WHITE WITH REVERSIBLE
MATTE WHITE / WEATHERED WOOD BLADES

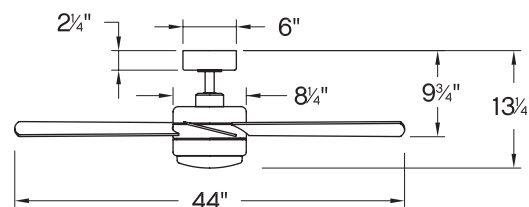

44" VENTUS™

902844FMW-LIA - MATTE WHITE

902844FMM-LIA - METALLIC MATTE BRONZE

902844FPW-LIA - PEWTER

BLADES:

- 3 Wood Blades Included
- 14° Blade Pitch
- 44" Blade Sweep

MOUNTING:

- 4.5" Downrod Included
- 76" Lead Wire
- 14.02lbs. Hanging Weight
- Mounts to Sloped Ceilings
- Up to 20° Pitch

Slope ceiling kit required for ceiling pitch greater than 20°, 992001FXX, see page 62.

LAMPING:

- 16w Integrated LED
- 1500 Lumens | 90 CRI | 3000K
- Dimmable
- Etched Opal Glass

INCLUDED CONTROLS:

980030FWH

Wall Control 3 Speed
Manual Reverse





902844FMM-LIA
METALLIC MATTE BRONZE WITH REVERSIBLE
METALLIC MATTE BRONZE / WALNUT BLADES



902844FPW-LIA
PEWTER WITH REVERSIBLE
DRIFTWOOD / TEAK BLADES

REVERSIBLE BLADES:



MATTE WHITE
Matte White /
Weathered Wood



**METALLIC MATTE
BRONZE**
Metallic Matte Bronze /
Walnut



PEWTER
Driftwood / Teak

OPTIONAL ACCESSORIES:

For additional finishes,
accessories and specifications,
see page 60.



932028FMW
Light Kit Cover

ADDITIONAL SIZES:

Also available in 52" diameter,
refer to hinkley.com.

OPTIONAL CONTROLS:

1. **980004FWH-0284**
WiFi Remote Control 44" Ventus

2. **980017FWH-0284**
WiFi Wall Control 44" Ventus



WiFi compatible with optional
controls.

PERFORMANCE SPECIFICATIONS	STANDARD	
	HIGH SPEED	AVERAGE
AIRFLOW (CFM)	3604	2732
ENERGY USE (WATTS)	56.7	38
AIRFLOW EFFICIENCY (CFM/W)	64	71
ENERGY COSTS (YEARLY)	\$16.00	\$11.00
AMPS	0.48	0.39
RPMS	196	146

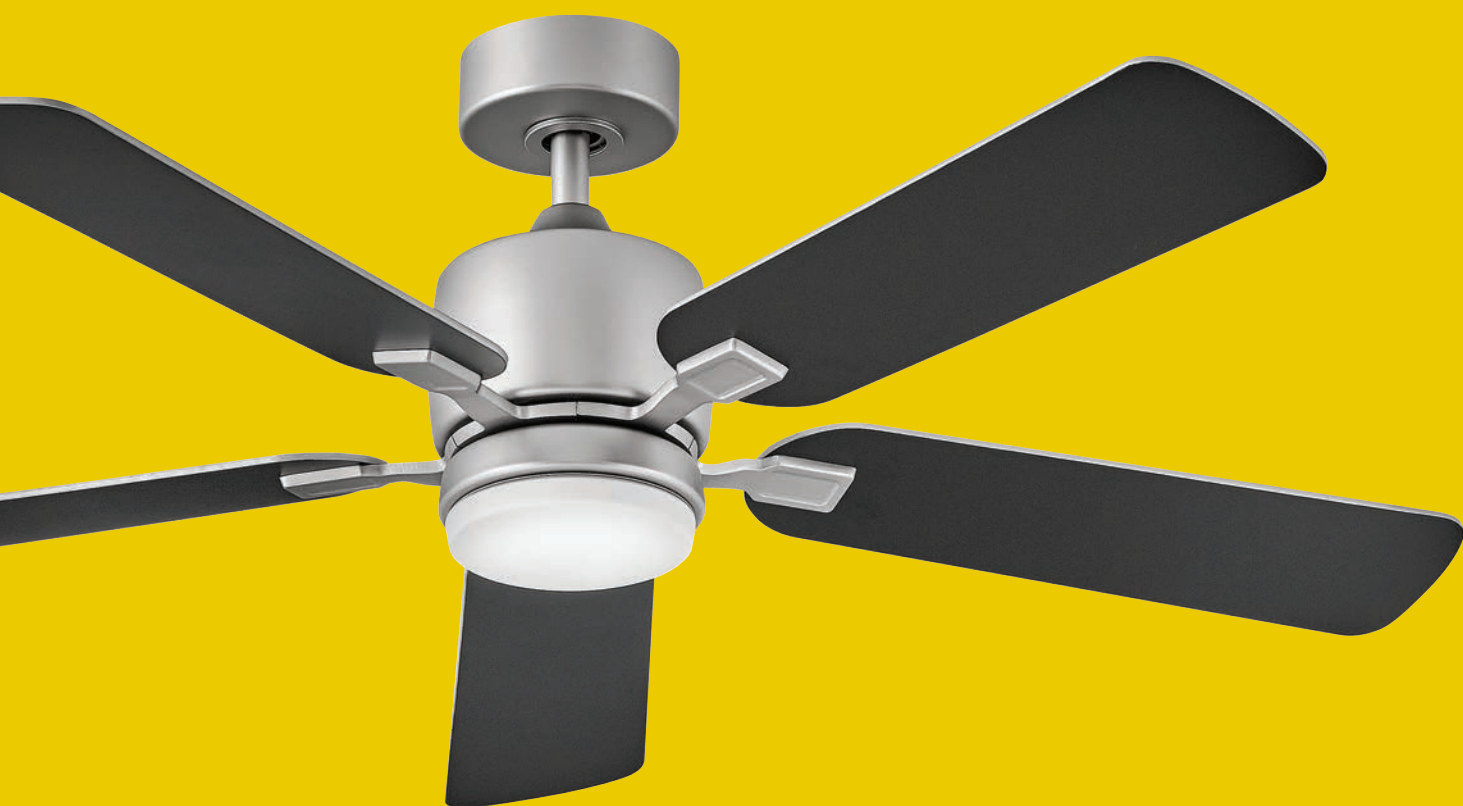

REGENCY SERIES

The Regency Series offers all purpose, affordable ceiling fans that can enhance a variety of spaces.

52" AFTON	48	52" METRO WET	58
52" METRO	54	52" OASIS	52
52" METRO ILLUMINATED	56	60" OASIS	50

[EXPLORE THE REGENCY SERIES >](#)

52" AFTON™

Clean and modern meets absolute practicality in Afton, making it the ultimate transitional ceiling fan. Afton is available in a robust lineup of finishes, including Chalk White with Chalk White blades, Satin Steel with Matte Black or Silver blades, Matte Black with Matte Black or Silver blades, and Metallic Matte Bronze with Metallic Matte Bronze or Walnut blades. Afton is part of the Regency Collection.



903552FSS-LIA
STAINLESS STEEL WITH REVERSIBLE
MATTE BLACK / SILVER BLADES

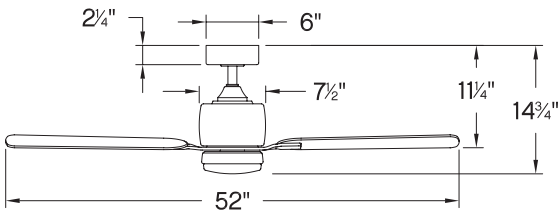

52" AFTON™

- 903552FCW-LIA - CHALK WHITE
- 903552FMB-LIA - MATTE BLACK
- 903552FMM-LIA - METALLIC MATTE BRONZE
- 903552FSS-LIA - STAINLESS STEEL

BLADES:

- 5 Wood Blades Included
- 12° Blade Pitch
- 52" Blade Sweep

MOUNTING:

- 4.5" Downrod Included
- 76" Lead Wire
- 18.19 lbs. Hanging Weight
- Mounts to Sloped Ceilings
- Up to 20° Pitch

Slope ceiling kit required for ceiling pitch greater than 20°, 992001FXX, see page 62.

LAMPING / GLASS:

- 16w LED Included
- 1500 Lumens | 90 CRI | 3000K
- Dimmable
- Etched Opal Glass

INCLUDED CONTROLS:

- 980008FWH
Wall Control Dual Slide
Non-Reversing





903552FCW-LIA
CHALK WHITE WITH CHALK WHITE BLADES



903552FMB-LIA
MATTE BLACK WITH SILVER ACCENTS AND
REVERSIBLE MATTE BLACK / SILVER BLADES



903552FMM-LIA
METALLIC MATTE BRONZE WITH REVERSIBLE
METALLIC MATTE BRONZE / WALNUT BLADES

OPTIONAL ACCESSORIES:

For additional finishes, accessories and specifications, see page 60.

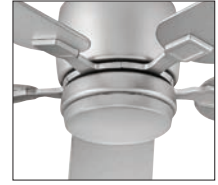

932014FSS
Light Kit Cover

REVERSIBLE BLADES:



MATTE BLACK
Matte Black / Silver



METALLIC MATTE BRONZE
Metallic Matte Bronze / Walnut



STAINLESS STEEL
Matte Black / Silver

OPTIONAL CONTROLS:

- 980004FWH-035**
Remote LF AC w/ WiFi Receiver
52" Afton
- 980017FWH-035**
Wall Control LF AC w/ WiFi Receiver
52" Afton



WiFi compatible with optional controls.

PERFORMANCE SPECIFICATIONS	STANDARD	
	HIGH SPEED	AVERAGE
AIRFLOW (CFM)	4614	3162
ENERGY USE (WATTS)	55	34
AIRFLOW EFFICIENCY (CFM/W)	84	94
ENERGY COSTS (YEARLY)	\$15.00	\$9.00
AMPS	0.47	0.33
RPMS	146	101

60" OASIS™

Part of the Regency Series, Oasis offers a simple yet classic all-you-need design. It is available in Appliance White with Appliance White blades, Brushed Nickel with Silver blades, Chalk White with Chalk White blades, Graphite with Driftwood blades, Matte Black with Matte Black blades or Metallic Matte Bronze with Metallic Matte Bronze blades. Oasis is so versatile; it can be used for both indoor and outdoor spaces. Blades are included with every fan.

DESIGN NOTE

Oasis housing and components are constructed of composite materials to offer maximum durability in harsh climates.



901660FCW-NWA
CHALK WHITE WITH
CHALK WHITE BLADES

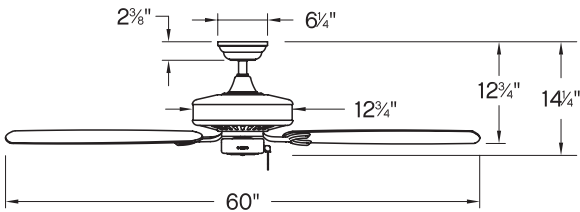

60" OASIS™

901660FBN-NWA - BRUSHED NICKEL

901660FCW-NWA - CHALK WHITE

901660FGT-NWA - GRAPHITE

901660FMB-NWA - MATTE BLACK

901660FMM-NWA - METALLIC MATTE BRONZE

BLADES:

- 5 Composite Blades Included
- 16° Blade Pitch
- 60" Blade Sweep

MOUNTING:

- 4.5" Downrod Included
- 76" Lead Wire
- 26.06lbs. Hanging Weight
- Mounts to Sloped Ceilings
 - Up to 26° Pitch

Slope ceiling kit required for ceiling pitch greater than 26°, 992001FXX, see page 62.

INCLUDED CONTROLS:

- Pull Chain
- 3 Speed Manual Reverse



901660FBN-NWA
BRUSHED NICKEL WITH
SILVER BLADES



901660FGT-NWA
GRAPHITE WITH
DRIFTWOOD BLADES



901660FMB-NWA
MATTE BLACK WITH
MATTE BLACK BLADES



901660FMM-NWA
METALLIC MATTE BRONZE WITH
METALLIC MATTE BRONZE BLADES

OPTIONAL ACCESSORIES:

For additional finishes, accessories and specifications, see page 60.



930006FBN
Light Kit Low Profile



930003FGT
Light Kit Small
Low Profile



910452FDR
Accessory Blades

OPTIONAL CONTROLS:

- 980004FWH-0166**
WiFi Remote Control 60" Oasis
- 980017FWH-0166**
WiFi Wall Control 60" Oasis



1.

2.



WiFi compatible with
optional controls.

PERFORMANCE SPECIFICATIONS	STANDARD	
	HIGH SPEED	AVERAGE
AIRFLOW (CFM)	5876	4038
ENERGY USE (WATTS)	79	48
AIRFLOW EFFICIENCY (CFM/W)	74	84
ENERGY COSTS (YEARLY)	\$22.00	\$13.00
AMPS	0.66	0.46
RPMS	140	96

52" OASIS™

Part of the Regency Series, Oasis offers a simple yet classic all-you-need design. It is available in Appliance White with Appliance White blades, Brushed Nickel with Silver blades, Chalk White with Chalk White blades, Graphite with Driftwood blades, Matte Black with Matte Black blades or Metallic Matte Bronze with Metallic Matte Bronze blades. Oasis is so versatile; it can be used for both indoor and outdoor spaces. Blades are included with every fan.

DESIGN NOTE

Oasis housing and components are constructed of composite materials to offer maximum durability in harsh climates.



901652FCW-NWA
CHALK WHITE WITH
CHALK WHITE BLADES

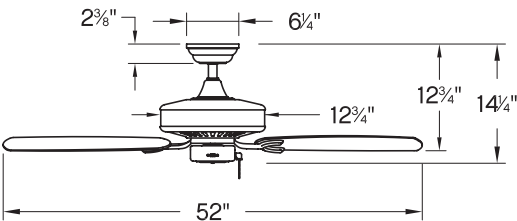

52" OASIS™

- 901652FAW-NWA - APPLIANCE WHITE
- 901652FBN-NWA - BRUSHED NICKEL
- 901652FCW-NWA - CHALK WHITE
- 901652FGT-NWA - GRAPHITE
- 901652FMB-NWA - MATTE BLACK
- 901652FMM-NWA - METALLIC MATTE BRONZE

BLADES:

- 5 Composite Blades Included
- 16° Blade Pitch
- 52" Blade Sweep

MOUNTING:

- 4.5" Downrod Included
- 76" Lead Wire
- 19.5lbs. Hanging Weight
- Mounts to Sloped Ceilings
- Up to 26° Pitch

Slope ceiling kit required for ceiling pitch greater than 26°, 992001FXX, see page 62.

INCLUDED CONTROLS:

- Pull Chain
- 3 Speed Manual Reverse



901652FBN-NWA
BRUSHED NICKEL WITH
SILVER BLADES



901652FGT-NWA
GRAPHITE WITH
DRIFTWOOD BLADES



901652FMB-NWA
MATTE BLACK WITH
MATTE BLACK BLADES



901652FMM-NWA
METALLIC MATTE BRONZE WITH
METALLIC MATTE BRONZE BLADES



901652FAW-NWA
APPLIANCE WHITE WITH
APPLIANCE WHITE BLADES

OPTIONAL ACCESSORIES:

For additional finishes, accessories and specifications, see page 60.



930006FBN
Light Kit Low Profile



930003FGT
Light Kit Small
Low Profile

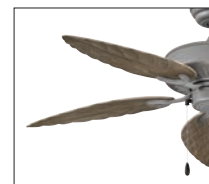

910452FDR
Accessory Blades

OPTIONAL CONTROLS:

- 980004FWH-016**
WiFi Remote Control 52" Oasis
- 980017FWH-016**
WiFi Wall Control 52" Oasis



WiFi compatible with
optional controls.

PERFORMANCE SPECIFICATIONS	STANDARD	
	HIGH SPEED	AVERAGE
AIRFLOW (CFM)	5455	3867
ENERGY USE (WATTS)	58.8	36
AIRFLOW EFFICIENCY (CFM/W)	93	106
ENERGY COSTS (YEARLY)	\$16.00	\$10.00
AMPS	0.49	0.35
RPMS	161	111

52" METRO™

Metro evokes a sense of timeless tradition to interiors of all styles. Metro is available in Brushed Nickel with Silver or Matte Black blades, Chalk White with Chalk White or Weathered Wood blades, Matte Black with Matte Black or Walnut blades, and Metallic Matte Bronze with Metallic Matte Bronze or Walnut blades. Metro is part of the Regency Collection.



Metro fans mount directly to canopy or with included downrod for dual mount capability. Minimum mounting height 9½".



903352FCW-NIA
CHALK WHITE WITH REVERSIBLE
WEATHERED WOOD / CHALK WHITE BLADES

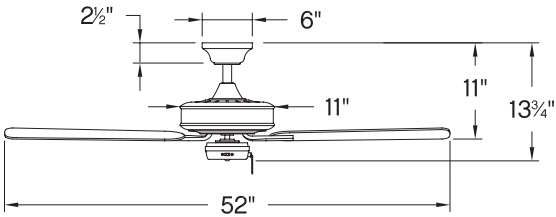

52" METRO™ INDOOR

- 903352FBN-NIA - BRUSHED NICKEL
- 903352FCW-NIA - CHALK WHITE
- 903352FMB-NIA - MATTE BLACK
- 903352FMM-NIA - METALLIC MATTE BRONZE

BLADES:

- 5 Wood Blades Included
- 13° Blade Pitch
- 52" Blade Sweep

MOUNTING:

- 4.5" Downrod Included
- 76" Lead Wire
- 15.87 lbs. Hanging Weight
- Mounts to Sloped Ceilings
 - Up to 20° Pitch

Slope ceiling kit required for ceiling pitch greater than 20°, 992001FXX, see page 62.

INCLUDED CONTROLS:

- Pull Chain
- 3 Speed Manual Reverse



903352FBN-NIA
BRUSHED NICKEL WITH REVERSIBLE
SILVER / MATTE BLACK BLADES



903352FMB-NIA
MATTE BLACK WITH REVERSIBLE
MATTE BLACK / WALNUT BLADES



903352FMM-NIA
METALLIC MATTE BRONZE WITH REVERSIBLE
WALNUT / METALLIC MATTE BRONZE BLADES

OPTIONAL ACCESSORIES:

For additional finishes, accessories and specifications, see page 60.



930005FAW-AM
Light Kit, Amber Cover



930005FAW-WF
Light Kit, White Cover



930008FBN
Light Kit, Schoolhouse

REVERSIBLE BLADES:



BRUSHED NICKEL
Matte Black / Silver



CHALK WHITE
Chalk White /
Weathered Wood



MATTE BLACK
Matte Black / Walnut



METALLIC MATTE BRONZE
Metallic Matte Bronze /
Walnut

OPTIONAL CONTROLS:

1. **980004FWH-033**
WiFi Remote Control 52" Metro

2. **980017FWH-033**
WiFi Wall Control 52" Metro



WiFi compatible with
optional controls.

PERFORMANCE SPECIFICATIONS	STANDARD		FLUSH MOUNT	
	HIGH SPEED	AVERAGE	HIGH SPEED	AVERAGE
AIRFLOW (CFM)	4672	3189	4553	3266
ENERGY USE (WATTS)	57.7	35	61.8	38
AIRFLOW EFFICIENCY (CFM/W)	81	90	73.7	86
ENERGY COSTS (YEARLY)	\$16.00	\$10.00	\$17.00	\$11.00
AMPS	0.49	0.35	0.52	0.38
RPMS	154	105	162	36

52" METRO™ ILLUMINATED

Metro Illuminated evokes a sense of timeless tradition to interiors of all styles. Metro Illuminated is available in Brushed Nickel with Silver or Matte Black blades, Chalk White with Chalk White or Weathered Wood blades, Matte Black with Matte Black or Walnut blades, and Metallic Matte Bronze with Metallic Matte Bronze or Walnut blades. Metro Illuminated features an LED lamp and is part of the Regency Collection.



Metro Illuminated fans mount directly to canopy or with included downrod for dual mount capability. Minimum mounting height 14".



903352FCW-LIA
CHALK WHITE WITH REVERSIBLE
CHALK WHITE / WEATHERED WOOD BLADES

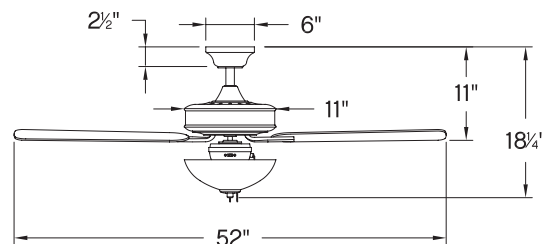

52" METRO™ ILLUMINATED

903352FBN-LIA - BRUSHED NICKEL

903352FCW-LIA - CHALK WHITE

903352FMB-LIA - MATTE BLACK

903352FMM-LIA - METALLIC MATTE BRONZE

BLADES:

- 5 Wood Blades Included
- 13° Blade Pitch
- 52" Blade Sweep

MOUNTING:

- 4.5" Downrod Included
- 76" Lead Wire
- 18.52 lbs. Hanging Weight
- Mounts to Sloped Ceilings
- Up to 20° Pitch

Slope ceiling kit required for ceiling pitch greater than 20°, 992001FXX, see page 62.

LAMPING / GLASS:

- 2-9w Med. LED Included
- 1620 Lumens | 90 CRI | 3000K
- Dimmable
- Etched Opal Glass

INCLUDED CONTROLS:

Pull Chain
3 Speed Manual Reverse



903352FBN-LIA
BRUSHED NICKEL WITH REVERSIBLE
MATTE BLACK / SILVER BLADES



903352FMB-LIA
MATTE BLACK WITH REVERSIBLE
WALNUT / MATTE BLACK BLADES



903352FMM-LIA
METALLIC MATTE BRONZE WITH REVERSIBLE
METALLIC MATTE BRONZE / WALNUT BLADES

OPTIONAL ACCESSORIES:

For additional finishes, accessories and specifications, see page 60.

REVERSIBLE BLADES:



BRUSHED NICKEL
Matte Black / Silver



CHALK WHITE
Chalk White /
Weathered Wood



MATTE BLACK
Matte Black / Walnut



METALLIC MATTE BRONZE
Metallic Matte Bronze /
Walnut

OPTIONAL CONTROLS:

- 1. 980004FWH-033L**
WiFi Remote Control 52" Metro
Illuminated
- 2. 980017FWH-033L**
WiFi Wall Control 52" Metro
Illuminated



WiFi compatible with
optional controls.

PERFORMANCE SPECIFICATIONS	STANDARD		FLUSH MOUNT	
	HIGH SPEED	AVERAGE	HIGH SPEED	AVERAGE
AIRFLOW (CFM)	4577	3129	4443	3196
ENERGY USE (WATTS)	58.3	36	61.8	38
AIRFLOW EFFICIENCY (CFM/W)	79	88	71.9	84
ENERGY COSTS (YEARLY)	\$16.00	\$10.00	\$17.00	\$11.00
AMPS	0.50	0.36	0.52	0.38
RPMS	154	105	162	36

52" METRO™ WET

The Metro Wet ceiling fan evokes a sense of timeless tradition to indoor and outdoor settings. Composed of Composite blades, Metro is available in Brushed Nickel with Silver blades, Chalk White with Chalk White blades, Matte Black with Matte Black blades, and Metallic Matte Bronze with Walnut blades. Wet-rated, Metro Wet is versatile enough to be used for both indoor and outdoor spaces and is part of the Regency Collection.



Metro Wet fans mount directly to canopy or with included downrod for dual mount capability. Minimum mounting height 9½".



903352FCW-NWA
CHALK WHITE WITH
CHALK WHITE BLADES

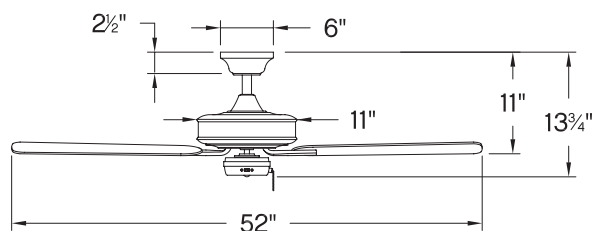

52" METRO™ WET

903352FBN-NWA - BRUSHED NICKEL

903352FCW-NWA - CHALK WHITE

903352FMB-NWA - MATTE BLACK

903352FMM-NWA - METALLIC MATTE BRONZE

BLADES:

- 5 Composite Blades Included
- 13° Blade Pitch
- 52" Blade Sweep

MOUNTING:

- 4.5" Downrod Included
- 76" Lead Wire
- 16.76 lbs. Hanging Weight
- Mounts to Sloped Ceilings
- Up to 20° Pitch

Slope ceiling kit required for ceiling pitch greater than 20°, 992001FXX, see page 62.

INCLUDED CONTROLS:

Pull Chain
3 Speed Manual Reverse



903352FBN-NWA
BRUSHED NICKEL WITH
SILVER BLADES



903352FMB-NWA
MATTE BLACK WITH
MATTE BLACK BLADES



903352FMM-NWA
METALLIC MATTE BRONZE
WITH WALNUT BLADES

OPTIONAL ACCESSORIES:

For additional finishes, accessories and specifications, see page 60.



930003FBN
Light Kit, Small Low Profile



930007FAW-WF
Light Kit, Heirloom Glass



930008FBN
Light Kit, Schoolhouse

OPTIONAL CONTROLS:

1. 980004FWH-033

WiFi Remote Control 52" Metro Wet

2. 980017FWH-033

WiFi Wall Control Receiver 52" Metro Wet



WiFi compatible with optional controls.



PERFORMANCE SPECIFICATIONS	STANDARD		FLUSH MOUNT	
	HIGH SPEED	AVERAGE	HIGH SPEED	AVERAGE
AIRFLOW (CFM)	4672	3189	4167	2884
ENERGY USE (WATTS)	57.7	35	57.6	35
AIRFLOW EFFICIENCY (CFM/W)	81	90	72.3	82
ENERGY COSTS (YEARLY)	\$16.00	\$10.00	\$16.00	\$10.00
AMPS	0.49	0.35	0.49	0.35
RPMS	154	105	152	34

LED LIGHT KITS

930003FXX - Light Kit Small Low Profile

	AVAILABLE FINISHES	AW - Appliance White
		BN - Brushed Nickel (shown)
		CW - Chalk White
		GT - Graphite
		MB - Matte Black
		MM - Metallic Matte Bronze
	GLASS	Etched Opal
	WIDTH	11" Dia.
	HEIGHT	5"
	LAMPING	16w Integrated LED 1500 Lumens 3000K 90 CRI



930007FXX - Light Kit Heirloom Glass

	AVAILABLE FINISHES	AW - Appliance White (shown)
		BN - Brushed Nickel
		CW - Chalk White
		GT - Graphite
		MB - Matte Black
		MM - Metallic Matte Bronze
	GLASS	Etched Opal
	WIDTH	10¼" Dia.
	HEIGHT	6¼"
	LAMPING	16w Integrated LED 1500 Lumens 3000K 90 CRI

930006FXX - Light Kit Low Profile

	AVAILABLE FINISHES	AW - Appliance White
		BN - Brushed Nickel
		CW - Chalk White
		GT - Graphite
		MB - Matte Black
		MM - Metallic Matte Bronze (shown)
	GLASS	Etched Opal
	WIDTH	11" Dia.
	HEIGHT	4½"
	LAMPING	16w Integrated LED 1500 Lumens 3000K 90 CRI



930008FXX - Light Kit Schoolhouse

	AVAILABLE FINISHES	AW - Appliance White
		BN - Brushed Nickel
		CW - Chalk White (shown)
		GT - Graphite
		MB - Matte Black
		MM - Metallic Matte Bronze
	GLASS	Etched Opal
	WIDTH	8¼" Dia.
	HEIGHT	7"
	LAMPING	1-9w Med. Base LED Lamp *Included 810 Lumens 3000K 90 CRI

930004FXX - Light Kit Rail Trim

	AVAILABLE FINISHES	AW - Appliance White
		BN - Brushed Nickel
		CW - Chalk White
		GT - Graphite (shown)
		MM - Metallic Matte Bronze
	GLASS	Etched Opal
	WIDTH	13½" Dia.
	HEIGHT	4¾"
	LAMPING	24w Integrated LED 2400 Lumens 3000K 90 CRI

930005FAW-WF - Light Kit White Bowl

930005FAW-AM - Light Kit Amber Bowl		
	GLASS	White Frosted / Amber Frosted
	WIDTH	11" Dia.
	HEIGHT	4½"
	LAMPING	2-9w Med. Base LED Lamps *Included 1620 Lumens 3000K 90 CRI
	AVAILABLE CAPS KITS	931001FAC Antique Copper
		931001FAW Appliance White
		931001FBN (shown) Brushed Nickel
		931001FCW Chalk White
		931001FGT Graphite
		931001FMB Matte Black
		931001FMM Metallic Matte Bronze
		931001FMW Matte White
		931001FPW Pewter
		931001FSS Satin Steel
	931001FXX Caps Kit	

930001FXX - Light Kit Large Low Profile

	AVAILABLE FINISHES	AC - Antique Copper (shown)
		BN - Brushed Nickel
		MM - Metallic Matte Bronze
		SS - Satin Steel
	GLASS	Etched Opal
	WIDTH	12" Dia.
	HEIGHT	3½"
	LAMPING	24w Integrated LED 2400 Lumens 3000K 90 CRI

LIGHT KIT COVERS

932001FXX - Artiste Light Kit Cover		
	AVAILABLE FINISHES	BN - Brushed Nickel (shown)
		GT - Graphite
		MM - Metallic Matte Bronze
		MW - Matte White
	WIDTH	8½" Dia.
	HEIGHT	2"

932027FXX - Trey Light Kit Cover		
	AVAILABLE FINISHES	BN - Brushed Nickel
		MM - Metallic Matte Bronze (shown)
		MW - Matte White
	WIDTH	9¾" Dia.
	HEIGHT	2¾"

932014FXX - Module Light Kit Cover		
	AVAILABLE FINISHES	BN - Brushed Nickel
		CW - Chalk White
		GT - Graphite
		MB - Matte Black (shown)
		MM - Metallic Matte Bronze
		SS - Stainless Steel
	WIDTH	7" Dia.
	HEIGHT	2¼"

932020FXX - Tier Light Kit Cover		
	AVAILABLE FINISHES	AW - Appliance White (shown)
		BN - Brushed Nickel
		MB - Matte Black
		MM - Metallic Matte Bronze
		MW - Matte White
	WIDTH	7½" Dia.
	HEIGHT	2½"

932007FXX - Hover Light Kit Cover		
	AVAILABLE FINISHES	BN - Brushed Nickel
		GT - Graphite (shown)
		MB - Matte Black
	WIDTH	7" Dia.
	HEIGHT	2"

932023FXX - Verge Light Kit Cover		
	AVAILABLE FINISHES	BN - Brushed Nickel
		MB - Matte Black
		MM - Metallic Matte Bronze
		MW - Matte White (shown)
	WIDTH	8½" Dia.
	HEIGHT	3¼"

932028FXX - Ventus Light Kit Cover		
	AVAILABLE FINISHES	MM - Metallic Matte Bronze
		MW - Matte White
		PW - Pewter (shown)
	WIDTH	7½" Dia.
	HEIGHT	2½"

ACCESSORY BLADES

5 BLADES PER SET
FOR USE WITH OASIS MODELS ONLY



910452FAW
52" Accessory Blade Set
Appliance White | Composite



910452FDR
52" Accessory Blade Set
Driftwood | Composite















910452FMH
52" Accessory Blade Set
Mahogany | Composite



910452FWW
52" Accessory Blade Set
Weathered Wood | Composite

DOWNRODS + MOUNTING ACCESSORIES

AVAILABLE FINISHES		12"	18"	24"	36"	48"	60"	72"
	AC Antique Copper	990012FAC 12" Downrod	990018FAC 18" Downrod	990024FAC 24" Downrod	990036FAC 36" Downrod	990048FAC 48" Downrod	990060FAC 60" Downrod	990072FAC 72" Downrod
	AW Appliance White	990012FAW 12" Downrod	990018FAW 18" Downrod	990024FAW 24" Downrod	990036FAW 36" Downrod	990048FAW 48" Downrod	990060FAW 60" Downrod	990072FAW 72" Downrod
	BN Brushed Nickel	990012FBN 12" Downrod	990018FBN 18" Downrod	990024FBN 24" Downrod	990036FBN 36" Downrod	990048FBN 48" Downrod	990060FBN 60" Downrod	990072FBN 72" Downrod
	BN-W Brushed Nickel (wet)	990012FBN-W 12" Downrod	990018FBN-W 18" Downrod	990024FBN-W 24" Downrod	990036FBN-W 36" Downrod	990048FBN-W 48" Downrod	990060FBN-W 60" Downrod	990072FBN-W 72" Downrod
	CW Chalk White	990012FCW 12" Downrod	990018FCW 18" Downrod	990024FCW 24" Downrod	990036FCW 36" Downrod	990048FCW 48" Downrod	990060FCW 60" Downrod	990072FCW 72" Downrod
	GT Graphite	990012FGT 12" Downrod	990018FGT 18" Downrod	990024FGT 24" Downrod	990036FGT 36" Downrod	990048FGT 48" Downrod	990060FGT 60" Downrod	990072FGT 72" Downrod
	HB Heritage Brass	990012FHB 12" Downrod	990018FHB 18" Downrod	990024FHB 24" Downrod	990036FHB 36" Downrod	990048FHB 48" Downrod	990060FHB 60" Downrod	990072FHB 72" Downrod
	MB Matte Black	990012FMB 12" Downrod	990018FMB 18" Downrod	990024FMB 24" Downrod	990036FMB 36" Downrod	990048FMB 48" Downrod	990060FMB 60" Downrod	990072FMB 72" Downrod
	MM Metallic Matte Bronze	990012FMM 12" Downrod	990018FMM 18" Downrod	990024FMM 24" Downrod	990036FMM 36" Downrod	990048FMM 48" Downrod	990060FMM 60" Downrod	990072FMM 72" Downrod
	MW Matte White	990012FMW 12" Downrod	990018FMW 18" Downrod	990024FMW 24" Downrod	990036FMW 36" Downrod	990048FMW 48" Downrod	990060FMW 60" Downrod	990072FMW 72" Downrod
	PW Pewter	990012FPW 12" Downrod	990018FPW 18" Downrod	990024FPW 24" Downrod	990036FPW 36" Downrod	990048FPW 48" Downrod	990060FPW 60" Downrod	990072FPW 72" Downrod
	SS Satin Steel	990012FSS 12" Downrod	990018FSS 18" Downrod	990024FSS 24" Downrod	990036FSS 36" Downrod	990048FSS 48" Downrod	990060FSS 60" Downrod	990072FSS 72" Downrod

991001FXX - Downrod Coupler		
	AVAILABLE FINISHES	AC - Antique Copper
		AW - Appliance White
		BN - Brushed Nickel
		CW - Chalk White
		GT - Graphite
		HB - Heritage Brass
		MB - Matte Black
		MM - Metallic Matte Bronze
		MW - Matte White
		PW - Pewter (shown)
		SS - Satin Steel
	WIDTH	1¾" Dia.
	HEIGHT	2"

992001FXX - Slope Ceiling Kit, up to 45°		
	AVAILABLE FINISHES	AC - Antique Copper
		AW - Appliance White
		BN - Brushed Nickel
		CW - Chalk White
		GT - Graphite
		HB - Heritage Brass
		MB - Matte Black
		MM - Metallic Matte Bronze (shown)
		MW - Matte White
		PW - Pewter
		SS - Satin Steel
	WIDTH	6" Dia.
	HEIGHT	3¼"

WALL CONTROLS - AC MOTOR FANS

980008FXX - Wall Control 4 Speed Dual Slide

	AVAILABLE FINISHES	AL - Almond
		WH - White (shown)
	TYPE / FUNCTION	Fan / Light 4 Speed Dual Slide
	AMPS	Max. 1.5
	DIMMING	Full Range
NOTES		Controls one AC fan only. Three wire control. Faceplate included.

980009FWH - Wall Control 3 Speed, On / Off Switch

	AVAILABLE FINISH	WH - White
	TYPE / FUNCTION	Fan / Light 3 Speed Slide Control On / Off Light Switch
	AMPS	Max. 1.25
	DIMMING	—
	NOTES	Controls one AC fan only. Three wire control. Faceplate included.

980010FAW - Wall Control 3 Speed Rotary

	AVAILABLE FINISH	AW - Appliance White
	TYPE / FUNCTION	Fan Only 3 Speed Rotary Control
	AMPS	Max. 1.25
	NOTES	Controls one AC fan only. Faceplate not included.

980011FXX - Wall Control 4 Speed Slide

	AVAILABLE FINISHES	AL - Almond (shown)
		WH - White
	TYPE / FUNCTION	Fan Only 4 Speed Slide Control
	AMPS	Max. 1.5
NOTES		Controls one AC fan only. Faceplate included.

980012FWH - Wall Control 3 Speed 5 Amp

	AVAILABLE FINISH	WH - White
	TYPE / FUNCTION	Fan Only 3 Speed Control Multiple Fans on One Circuit
	AMPS	Max. 5
	NOTES	Controls up to 3 AC fans. Faceplate included.

OPTIONAL CONTROLS

FOR USE WITH MARQUIS,
MARQUIS ILLUMINATED
AND WINDWARD ONLY

980007FXX - Wall Control 3 Speed

	AVAILABLE FINISHES	AL - Almond
		WH - White (shown)
	TYPE / FUNCTION	Fan / Light 3 Speed Control Full Function Reversing
	AMPS	Max. 1.5
	DIMMING	Full Range
NOTES		Controls one AC fan only. Faceplate included.

980005FWH - Remote Control 3 Speed

	AVAILABLE FINISH	WH - White
	TYPE / FUNCTION	Fan / Light 3 Speed Remote Control Full Function Reversing
	DIMMING	Full Range
	NOTES	Controls one AC fan only.

981002FAS - Receiver Switch Cup

	NOTES	Must be used with 981001FXX Switch Housing Cup. 980007FXX Wall Control or 980005FWH remote control required to operate 981002FAS.
---	--------------	---

981001FXX - Switch Housing Cup

	AVAILABLE FINISHES	AC - Antique Copper
		AW - Appliance White
		BN - Brushed Nickel (shown)
		CW - Chalk White
		GT - Graphite
		MB - Matte Black
		MM - Metallic Matte Bronze
		SS - Satin Steel
NOTES	Must be used with 981002FAS Receiver Switch Cup.	

INDEX

900982FBN-LDD	24	903352FMM-NWA	58	930006FXX	60
900982FMB-LDD	24	903552FCW-LIA	48	930007FXX	60
900982FMM-LDD	24	903552FMB-LIA	48	930008FXX	60
900982FMW-LDD	24	903552FMM-LIA	48	931001FXX	60
900999FBN-LDD	22	903552FSS-LIA	48	932001FXX	61
900999FMB-LDD	22	903660FGT-LDD	30	932007FXX	61
900999FMM-LDD	22	903660FMB-LDD	30	932014FXX	61
900999FMW-LDD	22	903680FGT-LDD	28	932020FXX	61
902928FMB-LWD	14	903680FMB-LDD	28	932023FXX	61
902928FMM-LWD	14	903744FGT-NDD	36	932027FXX	61
902928FMW-LWD	14	903744FMB-NDD	36	932028FXX	61
903056FBN-LID	16	903744FMW-NDD	36	980005FWH	63
903056FHB-LID	16	903752FGT-NDD	34	980007FXX	63
903056FMM-LID	16	903752FMB-NDD	34	980008FXX	63
903160FMM-NDD	18	903752FMW-NDD	34	980009FWH	63
903160FMW-NDD	18	903760FGT-NDD	32	980010FAW	63
903254FHB-LID	20	903760FMB-NDD	32	980011FXX	63
903254FMB-LID	20	903760FMW-NDD	32	980012FWH	63
903254FMM-LID	20	903860FGT-NDD	40	981001FXX	63
903254FPW-LID	20	903860FMB-NDD	40	981002FAS	63
903352FBN-LIA	56	903880FGT-NDD	38	990012FXX	62
903352FBN-NIA	54	903880FMB-NDD	38	990018FXX	62
903352FBN-NWA	58	910452FAW	61	990024FXX	62
903352FCW-LIA	56	910452FDR	61	990036FXX	62
903352FCW-NIA	54	910452FMH	61	990048FXX	62
903352FCW-NWA	58	910452FWW	61	990060FXX	62
903352FMB-LIA	56	930001FXX	60	990072FXX	62
903352FMB-NIA	54	930003FXX	60	991001FXX	61
903352FMB-NWA	58	930004FXX	60	992001FXX	61
903352FMM-LIA	56	930005FAW-AM	60		
903352FMM-NIA	54	930005FAW-WF	60		

We want you to enjoy your experience with Hinkley.

We're proud to be a 4th generation family company, and we love what we do. We've been designing and creating products with the same level and quality we put in our own homes since 1922. So whether you are flipping through our catalog, surfing our site, getting inspired through social media, chatting with a member of our team or checking out our designs with one of our retailers, we're always looking for your experience with Hinkley to be a positive one. Here's all you need to know:

CATALOG COLLECTIONS

Hinkley catalogs feature our current and complete product line along with important product specs and detailed photography. A must for the print-loving researcher who likes to tab their favorites. Stop by your local showroom for your own copy.

HINKLEY.COM

Dive in! Our easy-to-use site makes your product research process a snap, with the added benefit of tips, trends, installation guidelines and a quick connection to our retail partners.

#HINKLESTYLE

We love seeing how you live and sharing ideas and inspiration with each other. Stay in the loop on all Hinkley happenings, from your favorites styles, the best (seriously) giveaways, helpful tips, our latest collabs, Team Hinkley shenanigans, and brand new design drops. @hinkleylighting



TEAM HINKLEY

Want to chat? Contact us at customer care@hinkley.com or 1.800.HINKLEY.

Hinkley stands behind the quality of our lighting fixtures and ceiling fans with product warranties that are among the strongest in the industry. For details of warranty coverage on specific products, please refer to hinkley.com or consult a qualified Hinkley retail distributor.

Several Hinkley products are protected under U.S. Patent and foreign patent, or patent pending.

WELCOME TO THE FAMILY

We stand by every fixture we make but we know that sometimes things happen. Simply register your fixture so we can answer any questions as quickly as possible. Just head over to hinkley.com/register. We're always here if you have a question, need some help, or want to chat about our products.

©2021 Hinkley, Inc. All rights reserved in all copyrightable works.



Hinkley is a proud partner of the American Lighting Association.

HINKLEY

HINKLEY.COM

GLOBAL HEADQUARTERS

33000 Pin Oak Parkway | Avon Lake, Ohio 44012
T 440 653 5500 | F 440 653 5555 | hinkley.com

SHOWROOM

Dallas Trade Mart 3210 | Dallas, Texas 75207



Connect with us | [#hinkleystyle](https://twitter.com/hinkleystyle)

2021 FAN
SUPPLEMENT

FANSUP121

